

FC-9002 Pole Mount Bracket

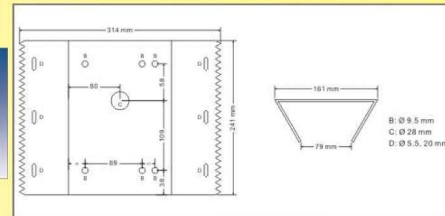

- Material: Steel
- Mounting Method: Bracket adapters are designed for mounting on columns
- Selectable Stainless Steel Ring: 6.5" (4.0" – 6.0") or 8.0" (6.0" – 7.5")
- FEVE Coating: Endure harsh environment, prevents acid and base moisture, five years warranty.
- Application: Suitable for FC-9009N / FC-9009 + FC-9010 / FC9014 + FC-9010



FC-9003 Pole Mount Bracket



- Material: Steel
- Mounting Method: Bracket adapters are designed for mounting on columns
- Selectable Stainless Steel Ring: 6.5" (4.0" – 6.0") or 8.0" (6.0" – 7.5")
- FEVE Coating: Endure harsh environment, prevents acid and base moisture, five years warranty.
- Application: Suitable for FC-9014 / FC-9015

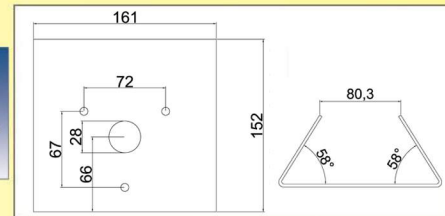

FC-9005 Pendant Mount Bracket



- Material: Bracket (Aluminum) and Power Box Panel (Steel)
- Mounting Method: Pendant
- Pipe Sizes Available: 10 cm, 20 cm, 30 cm, 50 cm.
- FEVE Coating: Endure harsh environment, prevents acid and base moisture, five years warranty.
- Application: Suitable for FC-16W / FC-27W / FC-27WN / FC-29W Series
- Application: FC-9005 (Bracket) + FC-9010 (Power Box)

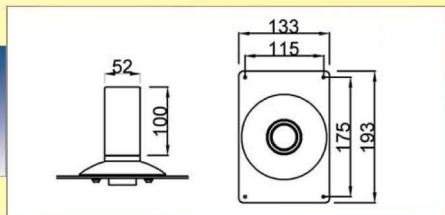

FC-9006 Pendant Mount Bracket



- Material: Aluminum
- Mounting Method: Pendant
- Pipe Sizes Available: 10 cm, 20 cm, 30 cm, 50 cm
- FEVE Coating: Endure harsh environment, prevents acid and base moisture, five years warranty.
- Application: Suitable for FC-16W / FC-27W / FC-27WN / FC-29W Series.

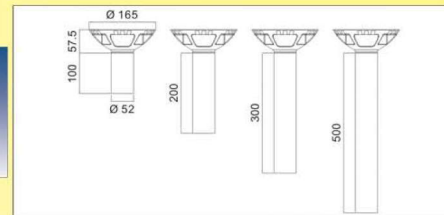

FC-9007 Exterior Angle 90° Corner Adapter



- Material: Steel
- Mounting Method: Wall
- FEVE Coating: Endure harsh environment, prevents acid and base moisture, five years warranty.
- Application: Suitable for FC-9009N / FC-9009 + FC-9010

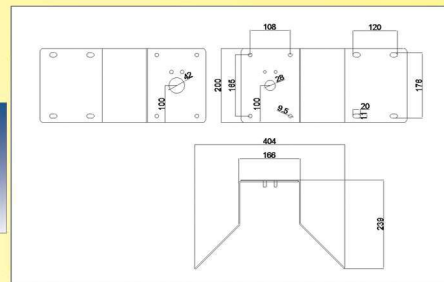

FC-9008 Interior Angle 90° Corner Adapter



- Material: Steel
- Mounting Method: Wall
- FEVE Coating: Endure harsh environment, prevents acid and base moisture, five years warranty.
- Application: Suitable for FC-9009N

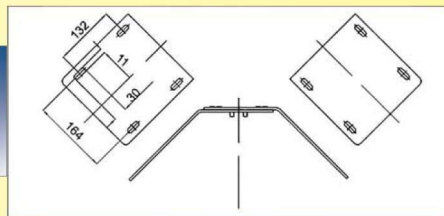

FC-9009 Wall Mount Bracket



- Material: Aluminum
- Mounting Method: Wall
- FEVE Coating: Endure harsh environment, prevents acid and base moisture, five years warranty.
- Application: Suitable for FC-16W / FC-27W / FC-27WN / FC-29W Series
- Application: For use with FC-9010 (Power Box)

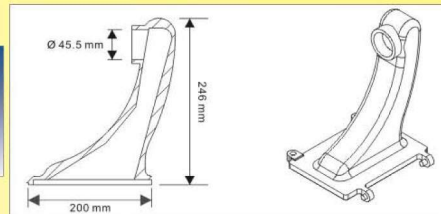

FC-9009N Wall Mount Bracket



- Material: Aluminum
- Mounting Method: Wall
- FEVE Coating: Endure harsh environment, prevents acid and base moisture, five years warranty.
- Application: Suitable for FC-16W / FC-27W / FC-27WN / FC-29W Series

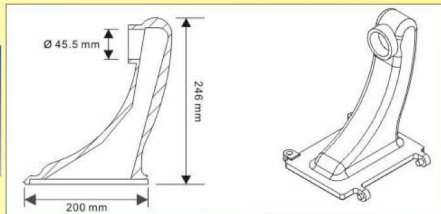

FC-9010 Power Box



- Material: Aluminum
- Mounting Method: Wall or Pendant
- A stainless steel retaining cable
- FEVE Coating: Endure harsh environment, prevents acid and base moisture, five years warranty.
- Application: Suitable for use with FC-9009 / FC-9005

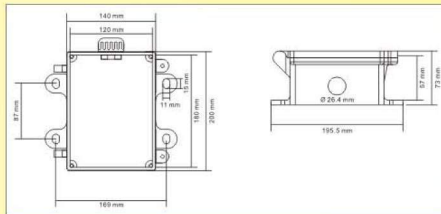

FC-9011 Pendant Mount Bracket



- Material: Aluminum and Steel
- Mounting Method: Pendant
- Pipe Sizes Available: 10 cm, 20 cm, 30 cm, 50 cm
- FEVE Coating: Endure harsh environment, prevents acid and base moisture, five years warranty.
- Application: Suitable for FC-16W / FC-27W / FC-27WN / FC-29W Series

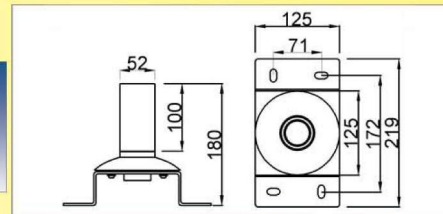

FC-9014 Housings Bracket



- Material: Aluminum
- Maximum Load: 10 kilograms
- Dimensions: 95 (W) x 100 (L) x 260 (H) mm
- Swivel Angle: 360°
- Tilt Angle: 90°
- Packing: 20 pieces in one carton

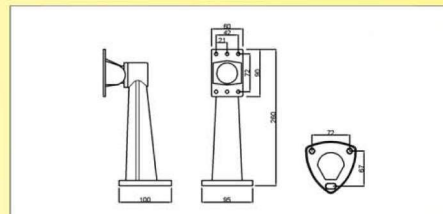

FC-9015 Housings Bracket



- Material: Aluminum
- Maximum Load: 10 kilograms
- Dimensions: 72 (W) x 93 (L) x 280 (H) mm
- Swivel Angle: 360°
- Tilt Angle: 90°
- Packing: 20 pieces in one carton

